

This architectural elevation drawing shows a building facade with three arched doorways. The drawing includes the following dimensions and level markers:

- Top Level Markers:**
 - +9.350 (top left corner)
 - +7.940 (top left of the central arch)
 - +8.140 (top right of the central arch)
- Central Archway Dimensions:**
 - 1 210 (height from top of arch to top of wall)
 - 2 960 (width of the arch opening)
 - 2 790 (height of the wall above the arch)
- Left Archway Dimensions:**
 - +6.770 (level marker above the arch)
 - +6.520 (level marker below the arch)
 - +5.150 (level marker below the arch)
 - 2 990 (width of the arch opening)
 - 2 770 (height of the wall above the arch)
 - ±0.000 (ground level marker below the arch)
- Right Archway Dimensions:**
 - +2.059 (level marker above the arch)
 - +1.649 (level marker below the arch)
 - 5 150 (height of the wall above the arch)
 - 2 400 (width of the arch opening)
 - 2 630 (height of the wall above the arch)
- Other Dimensions:**
 - 9 350 (total height from ground level to the top of the wall)
 - 1 140 (height of the wall above the central arch)
- Annotations:**
 - R 10 (radius of the arches, indicated by a red circle and a square symbol)

Technical drawing of a building facade showing two arched structures. The drawing includes elevation and dimension markings.

Elevation Markings:

- Top left: $+2.750$
- Top center: $+2.950$
- Top right: $+2.900$
- Bottom left: ± 0.000
- Bottom right: $+2.160$
- Far right: 4.800

Dimension Markings:

- Vertical dimension for the left arch: 2.210
- Vertical dimension for the right arch: 2.290
- Horizontal dimension for the right arch: 2.160
- Horizontal dimension for the right arch (inner): 2.290
- Horizontal dimension for the right arch (inner): 2.150
- Horizontal dimension for the right arch (inner): $+2.290$
- Horizontal dimension for the right arch (inner): $+2.365$
- Horizontal dimension for the right arch (inner): $+2.710$

Other Markings:

- A red circle with the text "R 10" is located near the bottom left of the right arch.

This architectural drawing shows a cross-section of a building. The central feature is a large rectangular room with a width of 3,100 units and a height of 4,830 units. Above this room is a smaller section with a curved top, measuring 1,970 units in width and 2,900 units in height. To the left of the main room, there is a small square area labeled "R 10". Various elevation points are marked: +7,730 at the top left corner, +7,930 at the peak of the curved roof, +4,830 at the bottom left corner, and +1,230 at the bottom right corner. A vertical dimension of 8,670 units spans from the base level (+1,230) to the top of the main room. Other dimensions include 1,230 units for the base width on the right, 740 units for the base depth, and ±0,000 for the ground level.

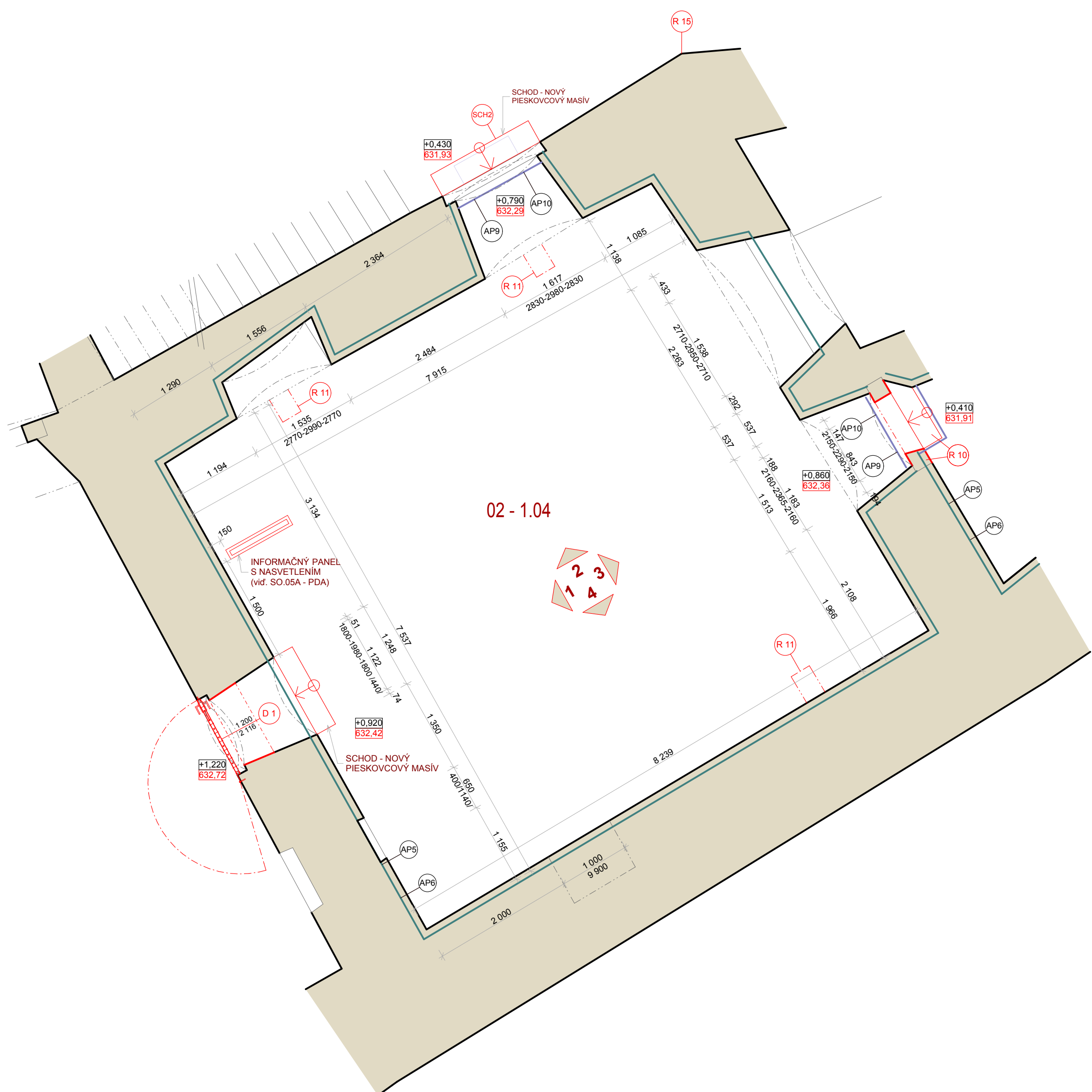

- PREDMET RIEŠENIA
- O 1** - OKNO
- Z 1** - ŽÁBRADLIE
- D 1** - DVERE
- R 1** - PŮVODNÉ PRVKY - ÚPRAVA REŠTAUROVANÍM
- AP1** - KOTVENIE HYDROIZOLÁCIE S OZNAČENÍM TYPU

	SO.01 - románsky palác
	SO.02 - západné paláce s kaplnkou
	SO.03 - kapitánsky dom (sociálno - hygienické zariadenie)
	SO.05A - úpravy plôch nádvorja (spevnené plochy, zelené plochy, opevnenie)
	SO.05B - odvedenie dažďovej vody
	SO.06 - sanácia hradného brala

(viazúce sa na stavebné objekty 1-6):

- SO.07 - kanalizácia (delená na splaškovú a dažďovú)
- SO.08 - voda
- SO.09 - silnoprúdové rozvody
- SO.10 - ochrana objektu pred účinkami blesku
- SO.11 - slaboprúdové rozvody

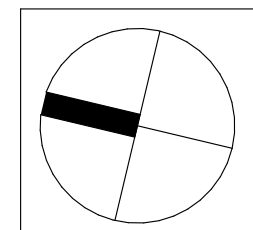
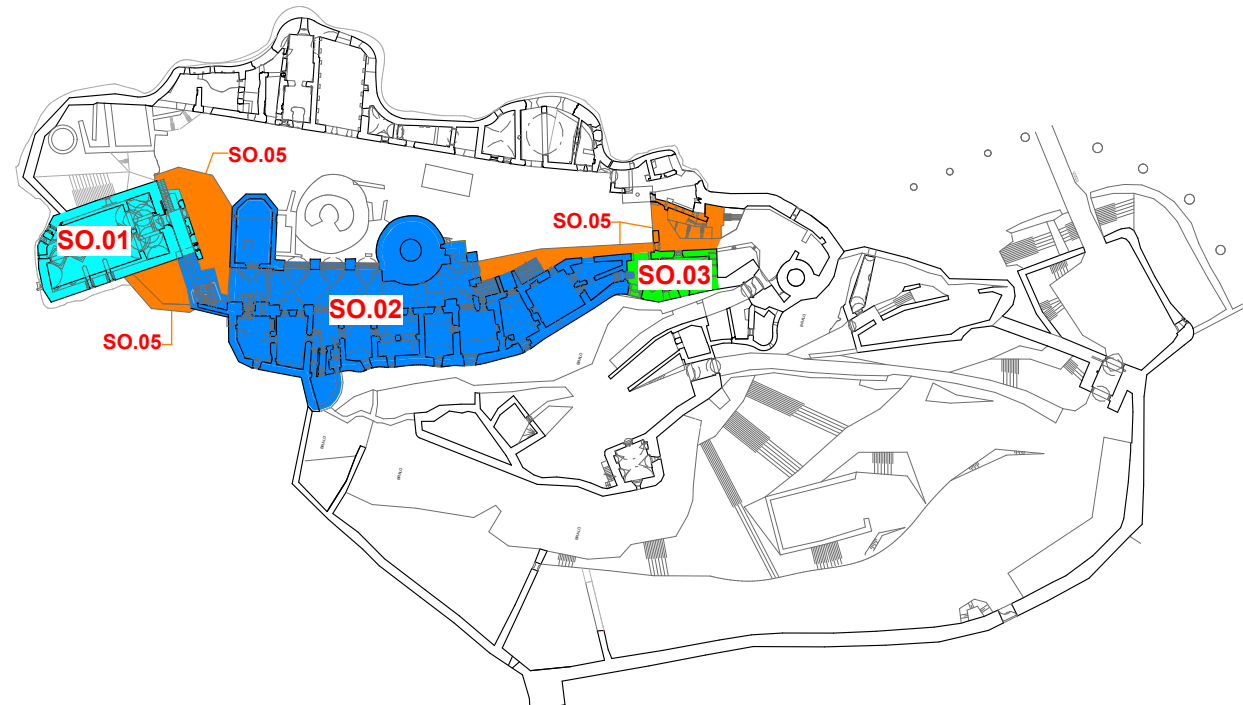

SADA Č.:



AUTORIZAČNÁ PEČIATKA

±0,000 = 631,50 m.n.m.		 ING. ARCH. MÁRIA ČUTKOVÁ AUTODISEGNO ARCHITECT S.R.O. tel.: 00421 91 77 22 790 e-mail: cutkova@gmail.com
DIEL:	ASR	
ZODP. PROJEKTANT:	ING. ARCH. M. JANOVSÁ, ING. ARCH. M. ČUTKOVÁ	
PROJEKTANT:	ING. ARCH. M. ČUTKOVÁ, ING. M. RATKOŠ, ING. M. Š	

AUTORI:	ING.ARCH. M. JANOVIŠKA, ING.ARCH. M. ČUTKOVA, ING.ARCH. J. DOLEŽAL		
SPOLUAUTORI:	ING.ARCH. R. BUČKO, ING.ARCH. M. DZURILLA, ING. V. SLOWIKOVÁ		
HLA. PROJEKTANT:	STÚDIO J + S s.r.o., VYSOKÁ 65, 054 01 LEVOČA		
ZODP. PROJEKTANT:	ING.ARCH. MAGDALENA JANOVIŠKA		
INVESTOR:	SLOVENSKE NÁRODNÉ MUZEUM, VAJANSKEHO NÁBRÉŽIE Č. 2, P.O.BOX 13, 810 06 BRATISLAVA 1		
NÁZOV AKCIE:	REKONŠTRUKCIA SPIŠSKÉHO HRADU, ROMÁNSKY PALÁC A ZÁPADNÉ PALÁCE		RP
	PROJEKTOVÁ DOKUMENTÁCIA PRE REALIZÁCIU STAVBY		DÁTUM: 09/2011
ČASŤ:	E - DOKUMENTÁCIA STAVEBNÝCH OBJEKTOV		MIERKA: 1 : 50
OBJEKT:	SO.02		ZÁK. Č.: 02/2011
DIEL:	ASR		FORMAT: 8 x A4
OBSAH VÝKRESU:	MIESTNOSŤ 02 - 1.04 - NAVRHOVANÝ STAV		VÝKR. Č.: 35.

PROJEKT ING. ARCH. MÁRIA ČUTKOVÁ
AUTORIZOVANÝ ARCHITEKT SR
tel.: 00421 51 77 22 790
e-mail: cutkova@gmail.com

77